

# **2006 - 2009 Cadillac XLR: Service Bulletin: #PI0299: Harsh Shifts After Replacement of 1-2-3-4 / 3-5-R Clutch Housing**

## **#PI0299: Harsh Shifts After Replacement of 1-2-3-4 / 3-5-R Clutch Housing - (Nov 16, 2010)**

**Subject:** Harsh Shifts After  
Replacement of 1-2-3-4 /  
3-5-R Clutch Housing

**Models:** 2006 - 2009 Cadillac  
XLR  
2006-2011 Cadillac STS  
2007-2011 Cadillac  
Escalade Models  
2008-2011 Cadillac CTS  
2006-2011 Chevrolet  
Corvette  
2007-2011 Chevrolet  
Silverado  
2008-2011 Chevrolet  
Suburban  
2009-2011 Chevrolet  
Avalanche, Tahoe  
2010-2011 Chevrolet  
Camaro, Express  
2007-2011 GMC Sierra,  
Yukon Denali, Yukon  
Denali XL  
2008-2011 GMC Yukon  
XL  
2009-2011 GMC Yukon

2010-2011 GMC Savana  
2008-2009 HUMMER  
H2  
2008-2009 Pontiac G8  
Equipped with 6L45,  
6L50, 6L80 or 6L90  
Automatic Transmission  
(RPOs MYA, MYB,  
MYC, MYD)

---

**Condition/Concern**

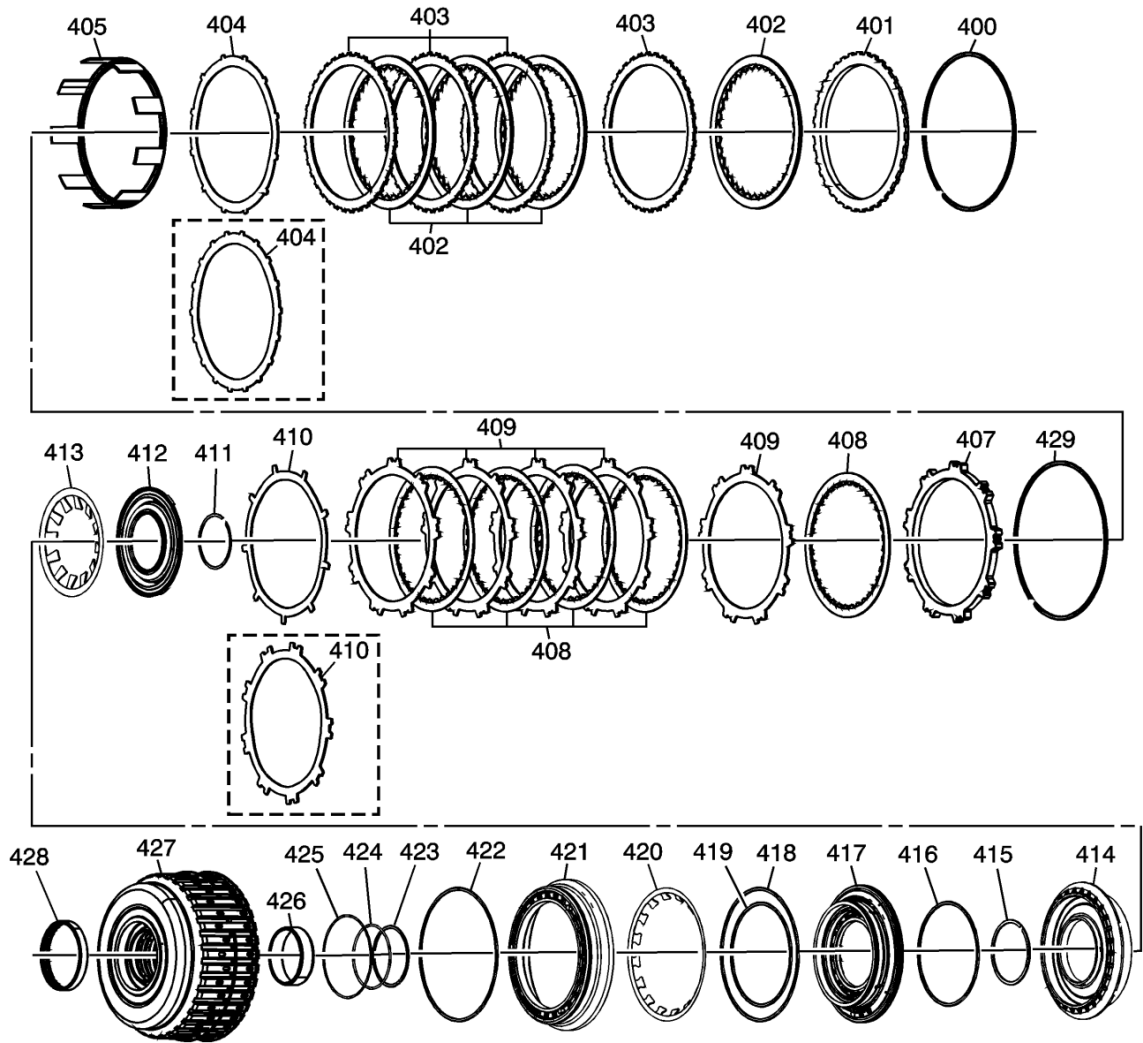

Some customers may comment on harsh shifts after replacement of the 1-2-3-4 / 3-5-R clutch housing (427).

## Recommendation/Instructions

**Note:** The parts catalog calls out to order the bearing when the housing is also replaced.

This condition may be caused if the 1-2-3-4 / 3-5-R bearing (428) is not installed into the housing (427). The 1-2-3-4 / 3-5-R clutch housing is currently serviced through parts without this bearing installed and failure to order and install this bearing may result in harsh shifts. Plans are being implemented to service this housing as a kit that will include the bearing.

Online URL:

<https://www.xlr-net.com/knowledgebase/article/2006-2009-cadillac-xlr-service-bulletin-pi0299-harsh-shifts-after-replacement-of-1-2-3-4-3-5-r-clutch-housing-149.html>